



Accessories Technical information

 **effeff**
ASSA ABLOY

Experience a safer
and more open world



About us.

Whatever you want to secure, protect, maintain –
we have the technology you require.





Elbphilharmonie Hamburg



HafenCity University Hamburg



Bauhaus Dessau



Stuttgart City Library

Breaking new grounds, implementing new technologies, developing new ideas.

Founded in 1936, the company effeff based in Albstadt became the market leader in the field of door control systems by following a consistent strategy.

After starting the electric strike production in 1947, a comprehensive product range has been gradually developed, which enables effeff to offer suitable solutions for every door.

February 1st, 2000, effeff joined the ASSA ABLOY Group based in Stockholm, Sweden and merged at the beginning of 2005 with IKON GmbH Präzisions-technik, Berlin who also belong to the group to become ASSA ABLOY Sicherheitstechnik GmbH.

IKON and effeff, both renowned and well-established brands within the market remain under ASSA ABLOY Sicherheitstechnik GmbH as do the production sites of Berlin and Albstadt.

ASSA ABLOY is the leading manufacturer and supplier of mechanical and electromechanical locks and related products worldwide. Our customers benefit from the extensive know-how of the largest international group of companies, meeting every requirement in terms of total security and comfort throughout the world.

We assist you with words and deeds

The experts at ASSA ABLOY Sicherheitstechnik would be pleased to advise you which electric strike model is most suitable for which installation position.

Hotline Technical advice

+49 7431 123-381

Hotline Sales/order processing

+49 7431 123-700

Technical advice

In the matter of technical advice, with us you will be supported by professionals who will continue to help you on every question on technical details. Of course you can also be put into contact with specialists for questions of detail in the matter of technical risk assessment or key accounts.

Sales advice/order processing

With our commercial customer services you can deal with all questions to do with your purchase order, for example the status of the order processing, the delivery date, purchase order changes, but also returns or guarantee issues. Use this simple and quick option to get information or help from our specialists. We will do that with pleasure.

Trade fairs

You will find effeff at many national and international trade fairs. You can obtain the exact dates from our website www.assaabloyopeningsolutions.de

Our product catalogue online at www.assaabloyopeningsolutions.de

Fast and up-to-date
comprehensive product
information at any time

1
Clearly arranged layout
according to our
different product
areas...

2
the submenu will help
you navigate through
our database...

3
to find the model you
need.

4
By just clicking on the
article, you can generate
a detailed specification
sheet.

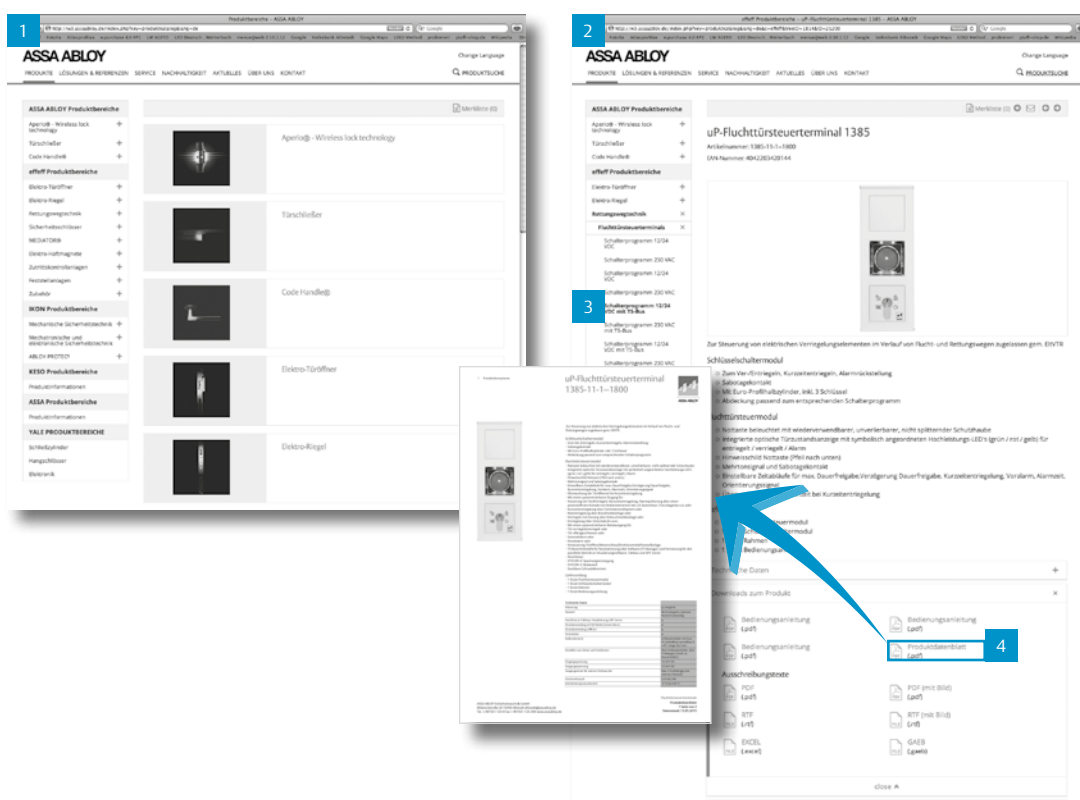

Table of Contents

About us	2 – 5
Explanations:	
Unrestricted public access despite locked door, model 750 / 7410-10	6 – 7
Automatic electric strike control	8
Digital timer switch	9
Alarm transmitter	10
Optical signals	11
Control buttons and switches	12 – 14
Switching elements	15
Contact locks	16 – 17
Distributor	18
Current transmitter	19
Power supplies	20 – 22
Rectifier	23
Throw-open device	24
Latch bolts	25
Monitoring contacts	
Introduction	26
Bolt switch contacts	
Bolt switch contacts	27 – 29
Magnetic contacts	
Introduction	30
Magnetic contacts	31 – 35
Mechanical contacts	36 – 37
Connecting cable	38
Pre-load electronic assembly	39
Lead covers	
Introduction	40
Lead covers without installation casing	41
Lead covers for concealed installation, 10 pin	42 – 47
Lead covers for concealed installation, 20 pin	48 – 51
Lead covers with integrated IO module	52
Accessories	53
Order form	54
Goods return form	55
Our products	56

Unrestricted public access despite locked door

Automatic Door Control Model 750



For premises such as doctor and lawyer practices

During visiting hours, the automatic control system operates electric strike release. When the system is engaged, the visitor rings the door bell and activates the automatic system in the electric strike control device. This releases the door for 1 to 10 seconds after the preset delay of between 1 to 20 seconds, enabling the visitor to enter. The door is then locked again as it closes. When the system is switched off, the electric strike is in normal mode.

The automatic electric strike control can be installed in all electric strike systems with effeff electric strikes (series 1 models).

Please note:

The overall system requires a minimum operating voltage of 8 V.

To ensure the system functions reliably over longer cable paths and small cable cross-sections, we recommend using transformers with a 12 V output voltage.

Electric strike voltage rating and voltage feed (transformer voltage) must match.

Electric strike models with the following order specifications can be used:

Series 1 models (fail-locked):

6-12 V order specification **D1**

8-16 V order specification **R1**

10-24 V order specification **A7**

12 V electric unlocking order specification **E3**

Do not use series 2 models (hold-open function)

Do not use series 3 models (fail-unlocked)

Installation:

Surface-mount installation or fit onto standard rail (distributor installation)

Technical specifications and order code on page 8.

Automatic electric strike control device

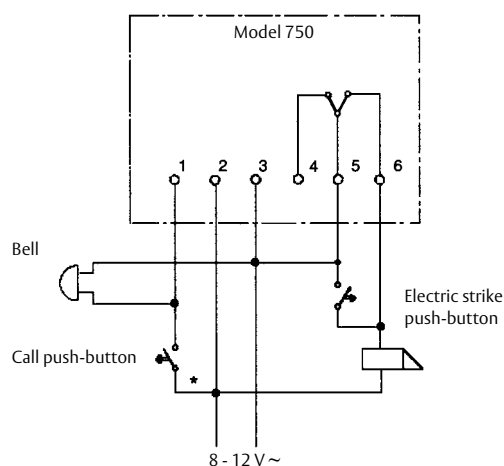

Automatic electric strike control device with bell system

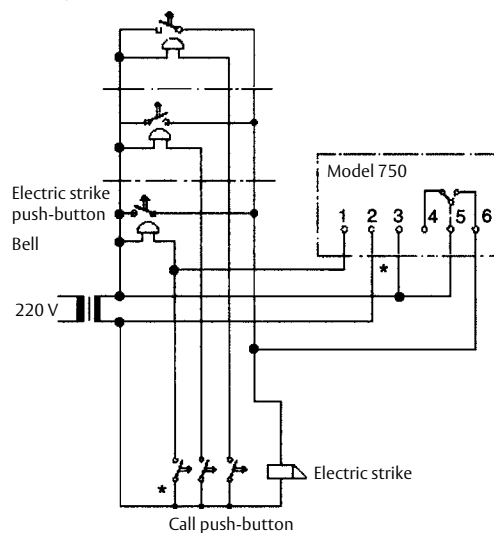

Important!

Use same potential for call push-button wire and terminal 2

Unrestricted public access despite locked door

Switchover device model 7410-10



For commercial buildings, offices, medical practices, schools and large apartment buildings

The entrance door is permanently unlocked automatically at certain times during the day, enabling visitors to come and go as they wish. The system is controlled by a timer switch. The electric strike is permanently unlocked by a continuous current at the times set on the time switch (DC operation, electric strike makes no buzzing sound). Outside these set times, the electric strike operates as normal, i.e. electric strike released via the electric strike button in the apartment.

(AC operation, electric strike makes no buzzing sound)

A complete system consists of the following individual components:

Electric strike, switchover device, timer, transformer rectifier, electric strike button.

Electric strike:

Always use electric strikes with 100% duty cycle, e.g. model 118-----A71 (12V 100%ED) or 118-----B71 (24V 100% duty cycle)

Installation:

Plastic casing for surface-mount installation, or fit onto standard rail (distributor installation)

Technical specifications and order code on page 8.

Diagram of Functions

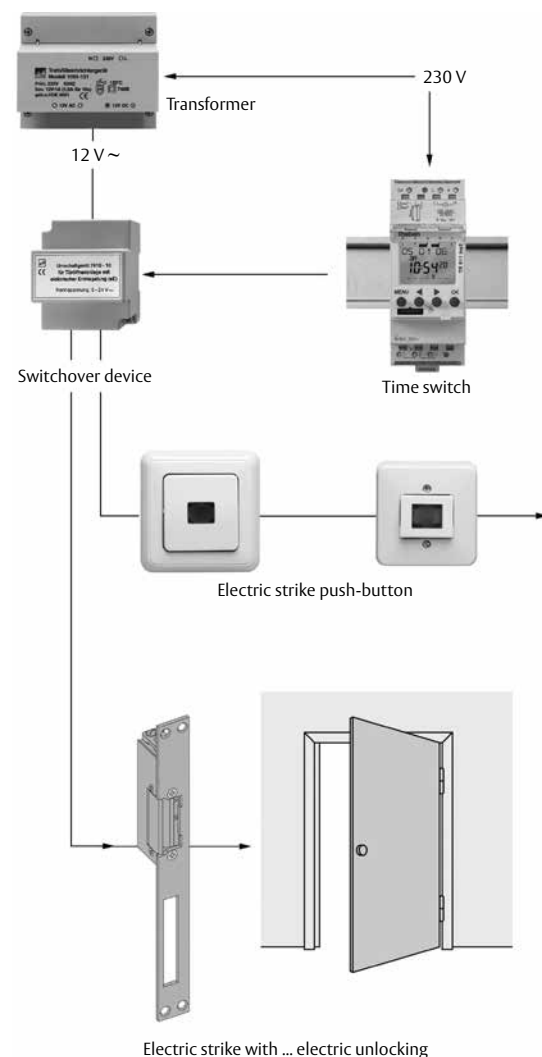

Circuit diagram for electric strike system with automatic electric unlocking controlled via timer switch

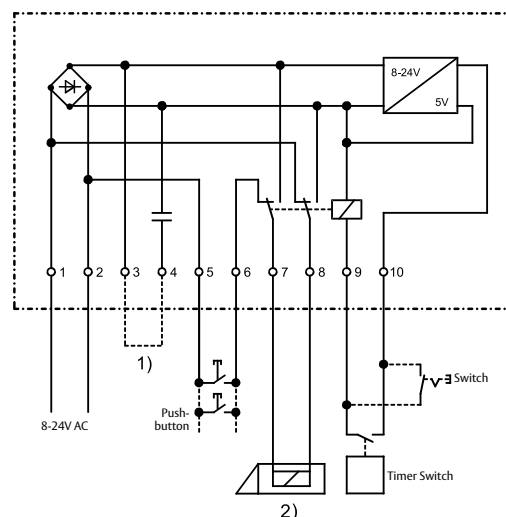

1) Warning: A bridge must be installed between terminals 3 and 4 for an 8V input voltage.

2) Electric strike (fail-locked) with electric unlocking (rated voltage according to connection voltage)
Contact rating for relay contacts: 1A

Automatic electric strike control



Automatic electric strike control model 750

Automatic electric strike control to ensure unrestricted public access despite locked door. For premises such as doctor and lawyer practices

Technical attributes	
Supply voltage	8 - 12 V AC
Mounting method	Surface-mounted/distributor installation
Adjustable waiting time	Approx. 1 to 20 sec
Release time	Approx. 1 to 10 sec
Height	98 mm
Width	88 mm
Depth	63 mm

Article / Feature	Order no.
For all fail-locked strike models; surface-mounted/top hat rail	7 5 0 - - - - - 0 0



Switchover device model 7410

For commercial buildings, offices, medical practices, schools and large apartment buildings. The entrance door is permanently unlocked automatically at certain times during the day. Visitors can come and go as they wish. The system is controlled by a separate timer switch.

Technical attributes	
Input operating voltage	8 - 24 V DC
Mounting method	Surface-mounted/distributor installation
Height	98 mm
Width	88 mm
Depth	63 mm

Article / Feature	Order no.
8 - 24 V AC; surface mounting/ top-hat rail	7 4 1 0 - 1 0 - - - - - 0 0

Digital timer switch



Digital timer Theben TR 610 top2, with daily and weekly program

Timer switches are a practical control device with a wide range of time settings for automatic locking and unlocking of doors. The timer system enables the door strike mode to be switched on and off automatically as the timer controls the door strike via a permanent contact. With microcomputer with combined daily and weekly program schedule. 56 freely programmable memory locations.

Technical attributes	
Supply voltage	230 V AC
Mounting method	Surface-mounted/distributor installation
Class of protection	IP 20
Width	35.8 mm
Height	90 mm
Depth	68 mm
Shortest switching interval	1 Min.
Memory locations	56 freely programmable locations
Floating switchover contact	Max. 16 A / 250 V AC

Article / Feature	Order no.
With daily and weekly program	2 0 3 2 - 1 0 - - - - - 0 0

Alarm transmitter



Alarm transmitter model 1200-10
Multi-tone siren in plastic casing for indoor installation

Technical attributes	
Input operating voltage	12 - 24 V DC regulated DC
Required power supply	12 V / 90 mA - 24 V / 80 mA
Audio frequency	adjustable
Pulsating alarm signalling	adjustable
Class of protection	IP 33
Continuous duty	100 % ED
Color	grey
Operating temperature range	-10 °C to +50 °C
Height	80 mm
Width	70 mm
Depth	78 mm

Article / Feature	Order no.
In plastic housing for indoor installation; protection class IP 33; 12 - 24 V DC	1 2 0 0 - 1 0 - - - - - 0 0

Optical signals

**Control signal Jung 938/10 U**

Light signal for electric strikes with monitoring and other control functions, screw-in bulb.

Technical attributes	
Mounting method	Flush-mounted
Material	plastic
Height	81 mm
Width	81 mm
Depth	30 mm

Article / Feature	Order no.
Red; 12 V; flush-mounted	1 0 5 0 R - U P - - - E 2 0
Red; 24 V; flush-mounted	1 0 5 0 R - U P - - - F 2 0

**Control signal Jung 938/10 U**

Light signal for electric strikes with monitoring and other control functions, screw-in bulb.

Technical attributes	
Mounting method	Flush-mounted
Color	red/green
Material	plastic
Height	152 mm
Width	81 mm
Depth	30 mm

Article / Feature	Order no.
Red/green; 12 V; flush-mounted	1 0 5 0 R / G - U P - - E 2 0
Red/green; 24 V; flush-mounted	1 0 5 0 R / G - U P - - F 2 0

Control buttons and switches



Push-button Jung 333AT-24
Surface-mounted push-button with key symbol

Technical attributes	
Mounting method	Surface-mounted
Width	61 mm
Height	61 mm
Depth	22 mm
Color	White
Contact type	Changeover contact

Article / Feature	Order no.
With key symbol; white; surface-mounted	1 0 1 0 - - - - - 0 0

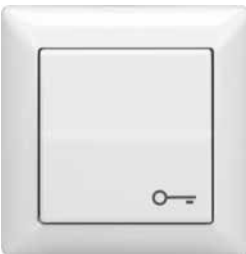

Push-button Jung 533 U, incl. frame and rocker switch
Flush-mounted push-button for flush-mounted switch box with key symbol

Technical attributes	
Mounting method	Flush-mounted
Width	81 mm
Height	81 mm
Color	White
Contact type	Changeover contact

Article / Feature	Order no.
With key symbol; white; flush-mounted	1 0 1 1 - - - - - 2 0



Push-button Jung 533 U
Flush-mounted push-button for flush-mounted switch box with key symbol

Technical attributes	
Mounting method	Flush-mounted
Width	81 mm
Height	81 mm
Surface	Stainless steel
Contact type	Changeover contact

Article / Feature	Order no.
With key symbol; stainless steel design; flush-mounted	1 0 1 1 - - - 6 3 5 3 5 0 0



Push-button Jung 533 U + 551 WU
Flush-mounted push-button for flush-mounted switch box with key symbol
Water-resistant for outdoor installation IP 44.

Technical attributes	
Mounting method	Flush-mounted
Width	81 mm
Height	81 mm
Color	White
Contact type	Changeover contact
Class of protection	IP 44

Article / Feature	Order no.
With key symbol; white; flush-mounted outside	1 0 1 2 - - - - - 2 0

Control buttons and switches

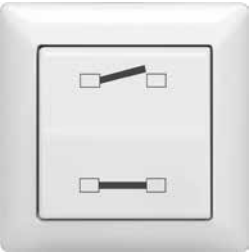

Changeover switch Jung 506 U

Changeover switch for flush-mounted switch box with door open/closed symbol. To control fail-unlocked current and permanently energised electric strikes.

Technical attributes	
Mounting method	Flush-mounted
Width	81 mm
Height	81 mm
Depth	22 mm
Color	White

Article / Feature		Order no.
With symbol door open/close; white; flush-mounted		3 8 8 3 - 1 0 - - - - - 2 0

Control buttons and switches



Interrupter switch Jung 533 U

Surface-mounted interrupter pushbutton with red actuator field, labelled 'Close door'. For controlling fail-unlocked components, such as holding magnets and fail-unlocked strikes, and as a manual switch / control for arrester systems. Changeover contact switch.

Technical attributes	
Width	85 mm
Height	85 mm
Depth	47 mm
Switching element	Changeover contact with neutral terminal

Article / Feature	Order no.
With red actuator field; inscription „Tür schließen“ (Close door); surface-mounted	1 3 1 6 - 1 0 - - - - - 0 0



Interrupter switch Jung 533 U

Flush-mounted interrupter pushbutton with red actuator field, labelled 'Close door'. For controlling fail-unlocked components, such as holding magnets and fail-unlocked strikes, and as a manual switch / control for arrester systems. Changeover contact switch

Technical attributes	
Width	80.5 mm
Height	80.5 mm
Depth	11 mm
Switching element	Changeover contact with neutral terminal

Article / Feature	Order no.
With red actuating field; inscription „lock door“; flush-mounted	1 3 1 7 - 1 0 - - - - - 0 0



Interrupter push-button Jung 633 W

Surface-mounted interrupter switch with illuminated red switch surface under protective glass. Suitable for outdoor use.

Technical attributes	
Function	Switch
Mounting method	Surface-mounted
Height	81 mm
Width	81 mm
Depth	55 mm

Article / Feature	Order no.
With red actuator field under protective glass; with lighting; 12 V AC/DC; surfacemounted	1 3 3 4 - - - - - E 1 0
With red actuating field under glass protection cover; with lighting; 24 V AC/DC; surface-mounted	1 3 3 4 - - - - - F 1 0



Interrupter switch Jung 533 U

Surface-mounted interrupter switch with illuminated red switch surface under protective glass.

Technical attributes	
Function	Switch
Mounting method	Flush-mounted
Width	81 mm
Height	81 mm
Depth	22 mm

Article / Feature	Order no.
With red actuating field under glass protection cover with lighting; 12 V AC/DC; surfacemounted	1 3 3 5 - - - - - E 1 0
With red actuating field under glass protection cover with lighting; 24 V AC/DC; surfacemounted	1 3 3 5 - - - - - F 1 0



Universal switching device model 7200

The universal switch devices are suitable for performing different tasks. They can be used for electric door strikes in: fail-locked mode with electrical permanent unlocking; failed-unlocked mode with or without monitoring contact.

The integrated rectifier provides a connection to the DC or AC switch for permanent unlocking. Button for short lock release Visual display of door status

Technical attributes	
Height	59 mm
Width	106 mm
Depth	100 mm
Color	Grey white (RAL 9002)

Article / Feature		Order no.
8 - 24 V AC/DC; grey white RAL 9002; desk		7 2 0 0 - 1 0 - - - 9 3 - 0 0

Contact locks



Contact lock GEBA MS-APZ 1

An operating unit to release doors against direction of escape (outdoors) in conjunction with escape door control unit.

Technical attributes	
Max. contact rating	24V / 2A
Type of cylinder	Designed for with profile half-cylinder; cam position 8 x 45°; 30.5 mm long
LED display	No
Mounting method	Surface-mounted
Class of protection	IP 54
Height	73.5 mm
Width	73.5 mm
Depth	45 mm

Article / Feature	Order no.
With momentary n.o. contact on both sides; surface-mounted	1 1 4 0 - 1 0 - - - - 0 0

Replacement momentary contact block GEBA M1T

With its inventive one-screw fitting system, the effeff security key switch range offers considerable advantage.

Technical attributes	
Class of protection	IP 54

Article / Feature	Order no.
For 1140-10 and 1140-11	1 1 4 0 - 1 0 - 0 1 - - - 0 0
For 1140-10 and 1140-11	1 1 4 0 - 1 0 - 0 2 - - - 0 0

Contact locks



GEBA MSR 1 contact lock

An operating unit to release doors against direction of escape (outdoors) in conjunction with escape door control unit.

Technical attributes	
Max. contact rating	24V / 2A
Height	100 mm
Mounting method	Flush-mounted
Type of cylinder	Designed for with profile half-cylinder; cam position 8 x 45°; 30.5 mm long
Depth	56 mm
Class of protection	IP 54
Width	90 mm
LED display	No

Article / Feature	Order no.
With momentary n.o. contact on both sides; flush-mounted	1 1 4 0 - 1 1 - - - - - 0 0

Contact lock GEBA S-APZ 1

With its inventive one-screw fitting system, the effeff security key switch range offers considerable advantages.

Technical attributes	
Max. contact rating	24V / 2A
Mounting method	Surface-mounted
Height	75 mm
Width	75 mm
Depth	65 mm
Class of protection	IP 54

Article / Feature	Order no.
with changeover contact on both sides, can be switched between keyed or latched on on each side	1 1 4 2 - 1 0 - - - - - 0 0



Contact lock GEBA S-EPZ 1

The standard, surface-mounted Model 1142-10 aP features a reversible key-lock switchover contact insert for momentary contact. Switch components have screw terminals and can be installed without the need for tools.

Technical attributes	
Max. contact rating	24V / 2A
Mounting method	Flush-mounted
Height	125 mm
Width	100 mm
Depth	65 mm
Class of protection	IP 54

Article / Feature	Order no.
with changeover contact on both sides, can be switched between keyed or latched on on each side	1 1 4 2 - 1 1 - - - - - 0 0



Profile-half cylinder

Profile half cylinder incl. 3 keys.

Technical attributes	
Height	33 mm
Width	17 mm
Length	30 mm
Surface	Matt, nickel-plated

Article / Feature	Order no.
For contact locks	2 . 0 5 0 7 - 0 0 3 0 0 0 0 0



Surface-mounted terminal block housing Hensel
To install escape door control unit and power supply.

Technical attributes	
Version	Surface-mounted
Class of protection	IP 44
Article / Feature	
1 rows; 12 HP	7 2 0 - V T 1 - I P 4 4 - 0 0
2 rows; 24 HP	7 2 0 - V T 2 - I P 4 4 - 0 0
3 rows; 36 HP	7 2 0 - V T 3 - I P 4 4 - 0 0



Steel plate housing
Empty housing with a continuous top hat rail for accommodating control modules with top hat rail mounting.

Technical attributes	
Dimension	300 x 186 x 125 mm
Class of protection	IP 30
Protection rating	1
Color	Grey white (RAL 9002)
Article / Feature	
Surface-mounted with top-hat rail	7 2 0 - V T 1 - S G - - - 0 0



Surface-mounted screw-type distributor 20-pin model 7458-20
20-pin distributor in plastic, surface-mounted version with screw-type terminals. Serves as an interconnection point between flexible cabling in the door and the building wiring installation, or as a junction point where clearly arranged wiring branches out to several door systems. With cover contact for sabotage monitoring.

Technical attributes	
Input operating voltage	max. 40 V DC
VdS class	Class C
Dimension	150 x 100 x 36 mm
Number of wires	20-pin
Operating temperature range	-25 °C to +65 °C
Article / Feature	
with cover contact	7 4 5 8 - 2 0 0 2 0 - - - 1 0

Current transmitter



Current transmitter 2-pin model 10305

Reliable power transmission from the door frame to the door leaf. Door contacts are mortise-fitted in the frame and in the door leaf. When the door is closed, the spring contacts touch and form an electrical circuit to the door strike.

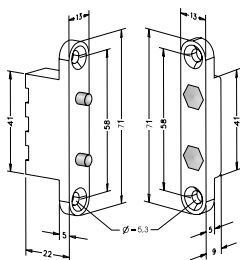

Drawings shows current transmitter without lugs

Technical attributes

Current intensity	1.5 A
Required power supply	24 V
On-time / off-time	max. 10 sec / 40 sec
Connection	Screw terminals
Height	71 mm
Width	13 mm
Contact pin material	Brass, nickel-coated

Article / Feature

Article / Feature	Order no.
2-pin	1 0 3 0 5 - - - - - 0 0
With plates; 2-pin	1 0 3 0 5 L A - - - - - 0 0



Current transmitter 3-pin model 10306

Reliable power transmission from the door frame to the door leaf. Door contacts are mortise-fitted in the frame and in the door leaf. When the door is closed, the spring contacts touch and form an electrical circuit to the door strike.

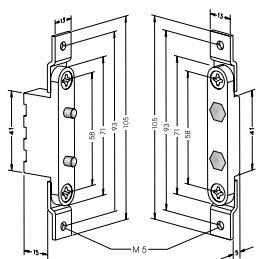

Drawings shows current transmitter with lugs

Technical attributes

Current intensity	1.5 A
Required power supply	24 V
On-time / off-time	max. 10 sec / 40 sec
Connection	Screw terminals
Height	71 mm
Width	13 mm
Contact pin material	Brass, nickel-coated

Article / Feature

Article / Feature	Order no.
3-pin	1 0 3 0 6 - - - - - 0 0
With clips; 3-pin	1 0 3 0 6 L A - - - - - 0 0



Transformer rectifier model 1001

The transformer rectifiers can supply an AC output and a DC output (50 % ripple), thus providing an optimum basis for power supply to electric strikes.

Technical attributes	
Rated current	1 A max., 1.5 A for 10 s
Mounting method	Surface-mounted / top hat rail
Overload protection	thermal circuit breaker
Dimension	106 x 70 x 73 (W x H x D)
Operating temperature range	0 °C to +40 °C
Class of protection	IP 20
Protection rating	II/Insulation protection

Article / Feature	Order no.
12 V AC and DC; 1 A; surface-mounted/top hat rail	1 0 0 1 - 1 2 - 1 - - - - 0 0
24 V AC and DC; 1 A; surface-mounted/top hat rail	1 0 0 1 - 2 4 - 1 - - - - 0 0

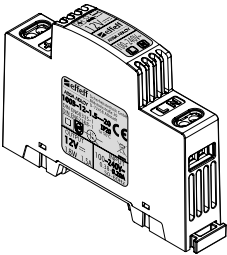

Power supply unit model 1003

The right mains receiver is available for every application in 12 VDC or 24 VDC. The individual mains receivers stand out due to their constant output voltage during fluctuations in mains voltage and load alternation.
The mains receivers with an output voltage according to the SELV requirement are used for access control systems and escape route systems, for example.

Technical attributes	
Overload protection	Electronical
Protection rating	II
Operating temperature range	-10°C + 50°C
Length	93 mm
Height	68 mm
Mounting method	Top-hat rail distributor
Class of protection	IP 20
Material housing	plastic
Approval DIN EN 60335-1	yes
Approval DIN EN 62368-1	yes

Article / Feature	Order no.
12 V DC, stabilised, 1.5 A, top-hat rail	1 0 0 3 - 1 2 - 1 . 5 - - 2 0
12 V DC, stabilised, 2.5 A, top-hat rail	1 0 0 3 - 1 2 - 2 . 5 - - 2 0
12 V DC, stabilised, 5 A, top-hat rail	1 0 0 3 - 1 2 - 5 - - - - 2 0
24 V DC, stabilised, 1.25 A, top-hat rail	1 0 0 3 - 2 4 - 1 . 2 5 - 2 0
24 V DC, stabilised, 2.5 A, top-hat rail	1 0 0 3 - 2 4 - 2 . 5 - - 2 0
24 V DC, stabilised, 4 A, top-hat rail	1 0 0 3 - 2 4 - 4 - - - - 2 0

Power supplies



Power supply module

The right mains receiver is available for every application in 12 VDC or 24 VDC. The individual mains receivers stand out due to their constant output voltage during fluctuations in mains voltage and load alternation.

The mains receivers with an output voltage according to the SELV requirement are used for access control systems and escape route systems, for example.

Technical attributes	
Nominal power	26 W
Max. continuous current	Nein
Output voltage	24 VDC SELV
Output current	1.08 A
Input operating voltage	230 VAC
Rated current consumption	0.24 A
Overload protection	Electronical
Protection rating	II
Operating temperature range	-10°C + 50°C
Height	32.5 mm
Mounting method	Switch box/distribution box
Class of protection	IP 20
Material housing	plastic
Diameter	54 mm
Approval DIN EN 60335-1	yes
Approval DIN EN 62368-1	yes

Article / Feature	Order no.
24 V DC, stabilised, 1 A	1 0 0 3 F T 2 4 - 1 - - - 2 0



Power supply module for switch box

These stabilised power supply units are used for access control, escape route systems and electric strike systems where a low-noise locking component is required.

Technical attributes	
Output voltage	12 V DC, stabilised
Input voltage	230 V AC +/- 15%
Rated current consumption	1 A
Mounting method	Flush-mounted switch box
Height	50,8 mm
Width	32 mm
Length	54,5 mm
Overload protection	Electronical
Operating temperature range	-20 °C to +40 °C
Class of protection	IP 20
Protection rating	II/Insulation protection
Material housing	plastic
Color	Black

Article / Feature	Order no.
12 V DC, stabilised, 1 A	1 0 0 3 U P - 1 2 - 1 - - 1 0

Power supplies



Emergency power supply 24VDC 3A top hat rail mounting; Comatec USV2030024E12RB

Uninterruptible AC/DC UPS with integrated charging level and battery management, with signal outputs for remote control. Connection terminals for load and battery. For distributor installation.

Technical attributes	
Operating voltage	230 V AC / $\pm 15\%$; 50/60 Hz
Output voltage	24.8 – 27.6 V DC (stabilised)
Output current	max. 3 A DC (72 W)
Operation condition	continuous
Connectable accumulator	max. 2 x 12 V / 4 Ah
Recommended accumulator	2 x 1006-BAT040--10
Mounting method	Distributor installation
Dimension	210 x 93 x 66.5 mm
Class of protection	IP20
Operating temperature range	-10 °C to + 40 °C
Function indicator	LED
Outputs for messages	Open-Collector, max. 24 VDC / 30 mA
Certified in compliance with	DIN EN 62368-1

Article / Feature	Order no.
24VDC 3A top hat rail mounting	1 0 0 6 - 2 4 0 3 0 - - - 1 0



Emergency power supply 24VDC, 3A in AP housing; COMATEC MDMB 0300 24 H

Uninterruptible AC/DC UPS with integrated charging level and battery management, with signal outputs for remote control. Connection terminals for load and battery. In surface-mounted plastic housing, complete with batteries.

Technical attributes	
Operating voltage	230 V AC / $\pm 15\%$; 50/60 Hz
Output voltage	24.8 – 27.6 V DC (stabilised)
Output current	max. 3 A DC (72 W)
Operation condition	continuous
Capacity	Rechargeable battery: 2 x 12 V / 7 Ah
Mounting method	Wall mount
Dimension	335 x 180 x 84 mm
Class of protection	IP20
Operating temperature range	-10 °C to + 40 °C
Function indicator	LED
Outputs for messages	Open-Collector, max. 24 VDC / 30 mA
Certified in compliance with	DIN EN 62368-1

Article / Feature	Order no.
24VDC, 3A in surface-mounted housing	1 0 0 6 - 2 4 0 3 0 A P - 1 0



Battery 12V/4AH in top hat rail housing; COMATEC BAT9/12V4AH

The BAT9/12V4AH battery module is specially designed for combination with emergency power supply model UPS2 in the terminal block housing. Notice: Two BAT9/12V4AH are required for 24 VDC operation.

Technical attributes	
Rated voltage	12 V DC
Capacity	4 Ah (hermetically sealed lead battery)
Installation	Top-hat rail distributor
Dimension	157.5 x 93 x 66.5 mm
Sub-units	9TE

Article / Feature	Order no.
Rechargeable battery 12V/4AH	1 0 0 6 - B A T 0 4 0 - - - 1 0

**Bridge rectifier model 1005-10**

For operation with electric strikes with alternating voltage, where no buzzing tone is wanted at permanent locking (eE, 100 % ED).

Technical attributes	
Input operating voltage	6 - 24 V AC
max. load capability in continuous use	0.5 A
max. load capability up to 10 seconds	1.4 A
Length	14 mm
Width	14 mm
Height	11.5 mm
Length of connection slots	150 mm

Article / Feature	Order no.
With connection slits; length 150 mm; 6 - 24 V AC	1 0 0 5 - 1 0 - - - - - 0 0

Throw-open device



Throw-open spring model 1020

For electric strikes with normal operation (single types). The door is opened slightly after contact is made. Suitable for normal doors.

Technical attributes	
Actuation force	10 N +/- 15 %
Actuation distance	4 mm
Height	162 mm
Width	10 mm

Article / Feature	Order no.
For strikes with failed-lock	1 0 2 0 - - - - - 0 0



Press-open bolt model 1021

For electric strikes with normal operation (single types). The door is opened slightly after contact is made. Suitable for normal doors.

Technical attributes	
Actuation force	25 N +/- 15 %
Actuation distance	8 mm
Height	25 mm
Width	12 mm
Diameter	12 mm

Article / Feature	Order no.
For strikes with failed-lock	1 0 2 1 - - - - - 0 0

Latch bolts



Mortise latch model 802

Small, easily mounted version. Is used for example as an additional locking mechanism in combination with fail unlocked electric strikes.

Technical attributes	
Height	55 mm
Width	20 mm
Depth	30 mm

Article / Feature	Order no.
For flush-mounting	8 0 2 - - - - - 0 0



Latch bolt model 804

Matching part for surface-mounted door strikes. Suitable for special structures. Is used as additional locking device with fail-unlocked door strike.

Technical attributes	
Height	20 mm
Width	34 mm
Depth	44 mm

Article / Feature	Order no.
Surface mounting	8 0 4 - - - - - 0 0



Mortise latch bolt lock model 807 squared

Mortise latch bolt locks for model series 807 are tested in accordance with applicable regulations and are approved as suitable mating components for electrical locking systems in doors along escape routes.

The latch bolt is adjustable from 11,5 mm to 17 mm (projection). This means that it can be adapted to the door gap on site thus ensuring actuation of the monitoring contact.

Technical attributes	
Version	Adjustable
Fixing holes	2
Depth	40 mm

Article / Feature	Order no.
Adjustable; 110 x 24 mm, angled striking plate	8 0 7 - 1 0 - - - - - 0 0
Adjustable; 135 x 20 mm; angular face plate	8 0 7 - 1 1 - - - - - 0 0



Mortise latch bolt lock model 807 radius

Mortise latch bolt locks for model series 807 are tested in accordance with applicable regulations and are approved as suitable mating components for electrical locking systems in doors along escape routes.

The latch bolt is adjustable from 11,5 mm to 17 mm (projection). This means that it can be adapted to the door gap on site thus ensuring actuation of the monitoring contact.

Technical attributes	
Version	Adjustable
Fixing holes	2
Depth	40 mm

Article / Feature	Order no.
Adjustable; 110 x 24 mm; radius face plate	8 0 7 - 1 2 - - - - - 0 0
Adjustable; 110 x 20 mm; radius striking plate	8 0 7 - 1 3 - - - - - 0 0

Monitoring contacts

Introduction

Monitoring contacts are divided into three basic types:

Bolt switch contacts

Bolt switch contacts are suitable for monitoring the door locking. To do so, a bolt switch contact is fitted into the frame striking plate in such a way that it is activated by the lock bolt. The signal can be evaluated or displayed in equipment such as alarm systems, building monitoring systems, panels as well as visual and acoustic alarm devices. Special strike plates are available for use in combination with electric door strikes (see Electric Strike catalogue).

Adjustable door contacts

Door contacts are suitable for monitoring door and window statuses. To do so, the door contact is normally fitted into the door or window frame. When the door or window is closed, the door contact is mechanically activated and the signal can be evaluated in a monitoring system.

Magnetic contacts

A magnetic contact is a detector for monitoring doors or windows. The magnetic contact consists of a reed contact and a permanent magnet. When the door or window is opened, the reed contact is opened as the magnet is removed, the magnetic field altered and the signal line interrupted.

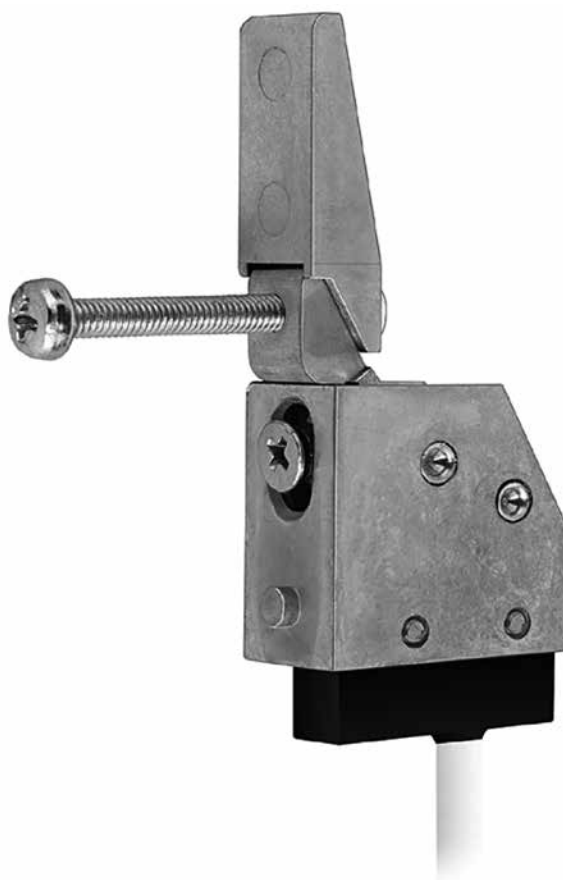

Bolt switch contacts



Bolt Switch Contact Model 878

Bolt switch contacts are suitable for monitoring door locking.

Due to the switching lever mounted in rotary bearings, there is no limit to the penetration of the dead bolt. The narrow design and the supplied mounting screw permit the bolt switch contact to be mounted in existing steel frames without striking plate through the bolt cut-out. This facility permits retrofitting also in already installed frames.

Technical attributes	
Max. switching voltage	25 V AC/DC
Switching contact	Change-over contact
Class of protection	IP 54
Response path	3 mm
Connecting cable	4 m
Max. switching current	2 A

Article / Feature	Order no.
Incl. 4 meter connecting cable; 3-wired	8 7 8 - - - - - 0 0



Bolt switch contact model 10308

Bolt switch contact for lock monitoring with adjustable switching point and two extensions for the actuating lever.

Technical attributes	
Max. contact rating	3 W
Input operating voltage	max. 30 VDC
Max. switching current	max. 0.3 A; observe the max. contact loading capacity!
Contact type	Change-over contact
VdS class	Class C
Class of protection	IP 50
Connection	Solder connection
Operating temperature range	-5 °C to +70 °C

Article / Feature	Order no.
VDS class C, soldered wires	1 0 3 0 8 - - - - - 1 0



Bolt switch contact model 10309.06

Bolt switch contact for lock monitoring with adjustable switching point and two extensions for the actuating lever.

Technical attributes	
Max. contact rating	3 W
Input operating voltage	max. 30 VDC
Max. switching current	max. 0.3 A; observe the max. contact loading capacity!
Contact type	Change-over contact
VdS class	Class C
Class of protection	IP 67
Connection cable length	6 m
Number of wires	3 wire
Operating temperature range	-5 °C to +70 °C

Article / Feature	Order no.
VDS class C, 6 m cable white	1 0 3 0 9 . 0 6 - - - - 1 0

Bolt switch contacts



Bolt Switch Contact Model 875-10 HZ

Due to the closed design of the housing, the dead bolt cutout is closed at the back as a special feature for steel frames and profiles. The profile interior is not visible. The dead bolt switch contact is first installed on the strike plate, then the strike plate will be fixed on the frame.

Technical attributes	
Max. switching voltage	25 V AC/DC
Switching contact	Change-over contact
Connecting cable	4 m
Max. switching current	2 A
Dead bolt penetration	18 mm
Class of protection	IP 54
Response path	4 mm

Article / Feature	Order no.
Without strike plate; with 4 meter connecting cable	8 7 5 - 1 0 - - - - - 0 0



Bolt Switch Contact Model 875-10 KL

Due to the closed design of the housing, the dead bolt cutout is closed at the back as a special feature for steel frames and profiles. The profile interior is not visible. The dead bolt switch contact is first installed on the strike plate, then the strike plate will be fixed on the frame.

Technical attributes	
Max. switching voltage	25 V AC/DC
Switching contact	Change-over contact
Dead bolt penetration	18 mm
Class of protection	IP 54
Response path	4 mm
Connecting cable	4 m
Color	galvanized
Version	Short flat strike plate
Length	122,5 mm
Width	25 mm
Thickness	3 mm
Max. switching current	2 A

Article / Feature	Order no.
With short strike plate; zinc-coated; with 4 meter connecting cable	8 7 5 - 1 0 - 1 2 2 4 0 - 0 1

Bolt switch contacts

Drawings

Bolt switch contact model 878

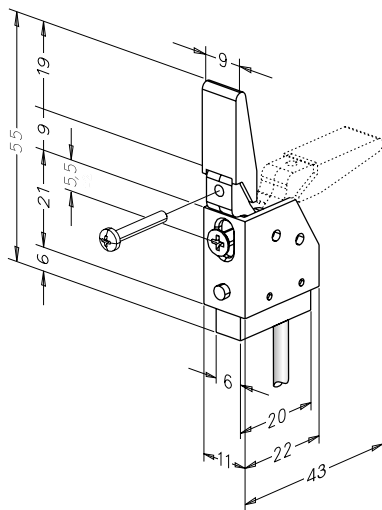

Bolt switch contact model 10308

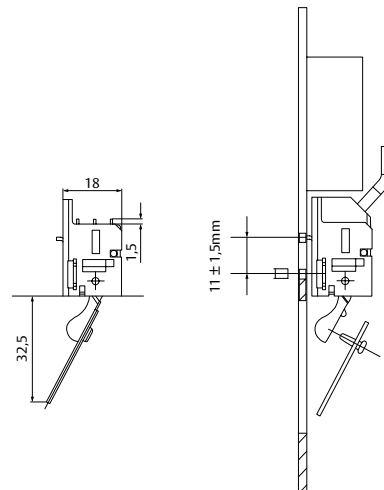

Bolt switch contact model 10309.06

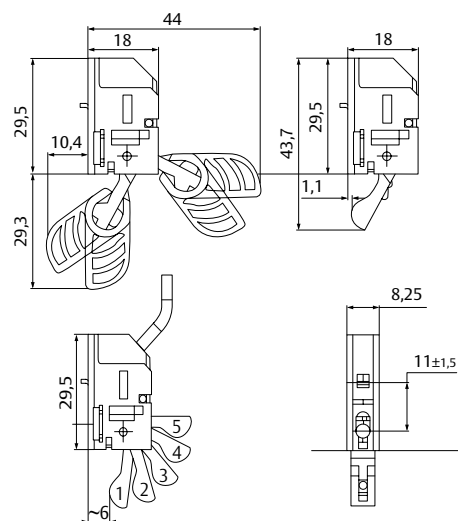

Bolt switch contact model 875-10 KL

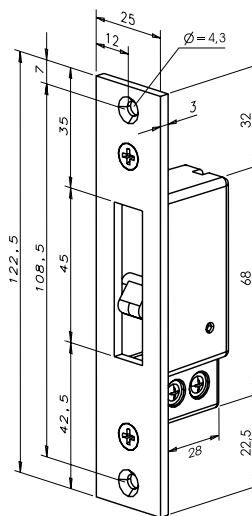

Bolt switch contact model 875-10

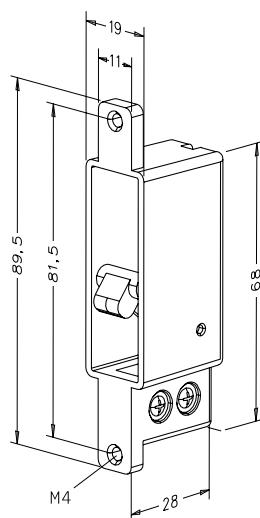

You can find suitable strike plates in the strike plate catalogue.
Please see the note „...pre-equipped for bolt switch contacts“.

Magnetic contacts

How they work:

Magnetic contacts basically consist of a reed contact and a permanent magnet. Reed contacts contain a switch which has been fused into a glass capillary tube to make it dust-proof and waterproof. Reed contacts are contactless-activated by a permanent magnet. The reed contact is fitted to the door frame, for instance, while the magnet is fitted into or onto the door leaf. When the door is closed, the magnet acts on the contact (contact closed). If the door is opened beyond the respective sensing distance, the contact is interrupted (in a normally open contact type) or is switched over (in a switchover contact).

You can choose the right magnetic contact to suit your specific installation location from the many designs available with different sensing distances. The 10380 set of magnetic contacts offers a special advantage. These sets contain a reed contact, a round magnet, a surface-mounted casing and a flange casing which can all be tailored according to the structural conditions at their installation location. This ensures that you always have the right design for your needs on site. Besides the different models, we also offer you magnetic contacts with or without VdS approval in line with your requirements. You can choose between VdS Classes B and C, depending on the version.

Installation instructions:

Magnetisable materials, such as steel or iron, interfere with the magnetic field required for the switching process. Such interference leads to a reduction in the sensing distance. It is not possible to trigger the reed contact in locations completely surrounded by magnetisable materials, such as steel frames. Non-magnetisable screws (e.g. stainless steel, brass) should be used to attach magnetic contacts.

If installation in magnetisable materials cannot be avoided, you will need to use a test set-up to determine the remaining sensing distance.

Suitable assembly components for installing magnetic contacts are listed with the respective product description below.

We recommend using a multimeter or circuit indicator to detect and test the corresponding circuit and connecting wires.

Contact protection:

The specified electrical voltage, current and output are only valid for Ohm loads. The specified electrical values are maximum values which must not be exceeded, even for a short while.



Magnetic contacts



Reed contact set 10380

The set consists of a round reed contact, permanent magnet, 2 flange casings, 2 surface-mounted casings and 2 spacers; it is thus suitable for surface-mounted and mortise fitting in wood or aluminium windows and doors.

Technical attributes	
Max. switching current	max. 0.2 A; observe the max. contact loading capacity!
Contact type	Change-over contact
Max. sensing distance	side: 19 mm / front: 15 mm
Class of protection	IP 67
Dimension	depending on the mounting
Number of wires	3 wire
Color	White
Material housing	plastic
Operating temperature range	-25 °C to +70 °C

Article / Feature	Order no.
Changeover contact; with connection cable, 6 m long; white	1 0 3 8 0 U - 6 - - - - 1 0
Changeover contact; with connection cable, 10 m long; white	1 0 3 8 0 U - 1 0 - - - - 1 0



Flat reed contact model 10362-6

Suitable for surface fitting on doors and windows. Works reliably on doors and windows where a large sensing distance is required. 5 height adjustment plates are included in the scope of delivery.

Technical attributes	
Max. contact rating	10 W
Input operating voltage	max. 60 VDC
Max. switching current	max. 0.5 A; observe the max. contact loading capacity!
Contact type	Normal open
Max. switching interval	23 mm
VdS class	Class B
Class of protection	IP 67
Dimension	10 x 10 x 55 mm
Connection cable length	6 m
Number of wires	4 wire
Color	White
Material housing	plastic
Operating temperature range	-5 °C to +50 °C

Article / Feature	Order no.
VDS class B, 6 m cable white	1 0 3 6 2 - 6 - - - - - 1 0

Magnetic contacts



Recessed reed contact model 10360-6

Suitable for flush mounting in aluminium or wood doors and windows in conjunction with installation casings.

Technical attributes	
Max. contact rating	6 W
Input operating voltage	max. 40 VDC
Max. switching current	max. 0.5 A; observe the max. contact loading capacity!
Contact type	Normal open
Max. switching interval	19 mm
VdS class	Class B
Class of protection	IP 67
Dimension	60 x 9.3 x 9.3 mm
Connection cable length	6 m
Number of wires	4 wire
Color	White
Material housing	plastic
Operating temperature range	-40 °C to +70 °C

Article / Feature	Order no.
6 m cable white	1 0 3 6 0 - 6 - - - - - 1 0



Installation device model 10271-6

Compatible with recessed reed contacts in the 10360-6-----10 series; suitable for mortise fitting and height adjustment with aluminium profiles.

Technical attributes	
Dimension	94 x 18 x 12.5 mm
Color	White
Material housing	plastic

Article / Feature	Order no.
2-piece set	1 0 2 7 1 - 6 - - - - - 1 0



Recessed reed contact model 10270-6

Suitable for flush mounting in aluminium or wood doors and windows in conjunction with installation casings. The switch boxes are included in the scope of supply.

Technical attributes	
Max. contact rating	6 W
Input operating voltage	max. 40 VDC
Max. switching current	max. 0.5 A; observe the max. contact loading capacity!
Contact type	Normal open
Max. switching interval	15 mm
VdS class	Class C
Class of protection	IP 67
Dimension	76 x 13 x 11.5 mm
Connection cable length	6 m
Number of wires	4 wire
Color	White
Material housing	plastic
Operating temperature range	-40 °C to +70 °C

Article / Feature	Order no.
VdS class C, 6 m cable white	1 0 2 7 0 - 6 - - - - - 1 0

Magnetic contacts



Round reed contact model 10375-6

Suitable for mortise fitting in aluminium or wood doors and windows.

Technical attributes	
Max. contact rating	10 W
Input operating voltage	max. 60 VDC
Max. switching current	max. 0.5 A; observe the max. contact loading capacity!
Contact type	Normal open
Max. switching interval	14 mm
VdS class	Class B
Class of protection	IP 67
Dimension	Ø 6 x 19 mm
Connection cable length	6 m
Number of wires	4 wire
Color	White
Material housing	plastic
Operating temperature range	-5 °C to +50 °C

Article / Feature	Order no.
VDS class B, 6 m cable white	1 0 3 7 5 - 6 - - - - 1 0



Round reed contact model 10211-6

Suitable for mortise fitting in aluminium or wood doors and windows.

Technical attributes	
Max. contact rating	6 W
Input operating voltage	max. 40 VDC
Max. switching current	max. 0.5 A; observe the max. contact loading capacity!
Contact type	Normal open
Max. switching interval	16 mm
VdS class	Class B
Class of protection	IP 67
Dimension	Ø 8 x 31 mm
Connection cable length	6 m
Number of wires	4 wire
Color	White
Material housing	plastic
Operating temperature range	-40 °C to +70 °C

Article / Feature	Order no.
VDS class B, 6 m cable white	1 0 2 1 1 - 6 - - - - 1 0

Magnetic contacts



Round reed contact with flange model 10370-6
Suitable for flush fitting in aluminium-wood doors and windows

Technical attributes	
Max. contact rating	10 W
Input operating voltage	max. 60 VDC
Max. switching current	max. 0.5 A; observe the max. contact loading capacity!
Contact type	Normal open
Max. sensing distance	side: 24 mm / front: 18 mm
VdS class	Class A
Class of protection	IP 67
Dimension	Ø 6 x 30 mm
Connection cable length	6 m
Number of wires	2 wire
Color	White
Material housing	plastic
Operating temperature range	-5 °C to +50 °C

Article / Feature	Order no.
VDS class A, 6 m cable white	1 0 3 7 0 - 6 - - - - - 1 0



Round reed contact with flange model 10210-6
Suitable for mortise fitting in aluminium or wood doors and windows.

Technical attributes	
Max. contact rating	6 W
Input operating voltage	max. 40 VDC
Max. switching current	max. 0.5 A; observe the max. contact loading capacity!
Contact type	Normal open
Max. switching interval	16 mm
VdS class	Class B
Class of protection	IP 67
Dimension	Ø 8 x 31 mm
Connection cable length	6 m
Number of wires	4 wire
Color	White
Material housing	plastic
Operating temperature range	-40 °C to +70 °C

Article / Feature	Order no.
VDS class B, 6 m cable white	1 0 2 1 0 - 6 - - - - - 1 0

Magnetic contacts



Steel installation set 10296

Mounting component for installing the round reed contact 10210 or 10295 in ferromagnetic materials, such as steel. The set is made up of a mounting flange for the round magnets and for the magnets.

Technical attributes	
Dimension	Internal dimension 8 mm; External dimension: 20 mm
Color	White
Material housing	plastic

Article / Feature	Order no.
for 10295	1 0 2 9 6 - - - - - 1 0



Flange reed contact

Round reed contact with flange, suitable for flush fitting in aluminium-wood doors and windows.

Technical attributes	
Input operating voltage	max. 30 VDC
Max. contact rating	3 W
Contact type	Change-over contact
Number of wires	3 wire
Max. switching interval	15 mm
Dimension	Ø 8 x 31 mm
Operating temperature range	-25 °C to +70 °C
Color	White
Class of protection	IP 67
Material housing	plastic
Connection cable length	6 m
Max. switching current	max. 0.2 A; observe the max. contact loading capacity!

Article / Feature	Order no.
Changeover contact; with connection cable, 6 m length, with flange	1 0 3 8 2 U - 6 - - - - 1 0
Changeover contact; with connection cable, 10 m length, with flange	1 0 3 8 2 U - 1 0 - - - - 1 0



Universal Reed contact

Reed contact and magnet unit for monitoring when door or window is opened, with fitting concealed in the door or window rebate.

Technical attributes	
Max. switching current	max. 0.5 A; observe the max. contact loading capacity!
Contact type	Normal open
Max. sensing distance	14 mm
VdS class	Class B
Class of protection	IP 67
Dimension	95 x 18 x 8
Connection cable length	6 m
Number of wires	4 wire
Color	White
Material housing	plastic
Operating temperature range	-5 °C to +50 °C

Article / Feature	Order no.
VDS class B, 6 m cable white	1 0 3 6 8 - 1 0 - - - - 1 0

Mechanical contacts



Conical contact model 10405.10

It is characterized particularly by its hardwearing design with steel ball and screw thread for flexible setting to a wide range of different door geometries.

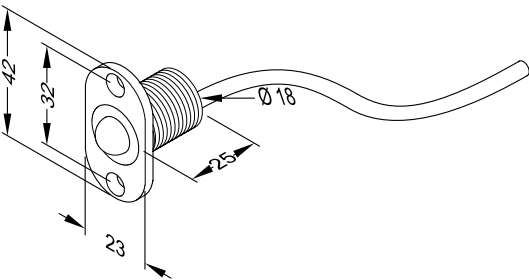
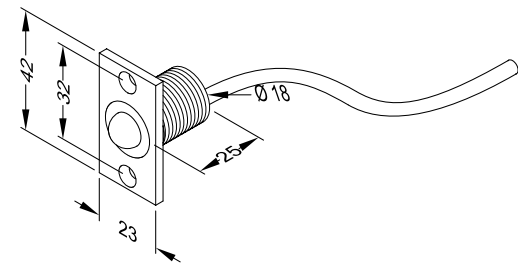

Technical attributes	
Class of protection	IP 40
Response path	1 mm
Adjustment path	13 mm
Diameter	18 mm
Connection	Connecting cable
Number of wires	3 wire
Life span	1 M switching cycles

Article / Feature	Order no.
With connecting cable; length 4 m; angled face plate	1 0 4 0 5 . 1 0 - - - - 0 0
With connecting cable; length 4 m; radius face plate	1 0 4 0 5 . 1 0 R - - - - 0 0



Conical contact model 10405.11

It is characterized particularly by its hardwearing design with steel ball and screw thread for flexible setting to a wide range of different door geometries.

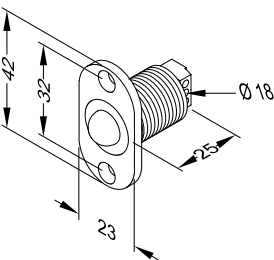
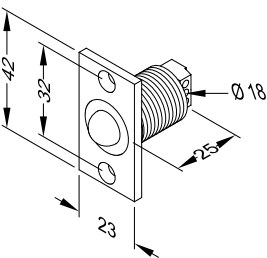

Technical attributes	
Class of protection	IP 40
Response path	1 mm
Adjustment path	13 mm
Diameter	18 mm
Connection	Screw terminals
Life span	1 M switching cycles

Article / Feature	Order no.
With connecting terminal; angled face plate	1 0 4 0 5 . 1 1 - - - - 0 0
With connecting terminal; Radius face plate	1 0 4 0 5 . 1 1 R - - - - 0 0

Mechanical contacts



Conical contact model 10400

Electromechanical contacts such as conical, pin and micro contacts are microswitches activated by a click switch movement (changeover contact). This ensures complete contact reliability. For mortise fitting (e.g. in frames)

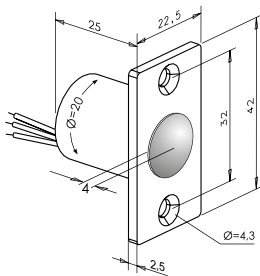

Technical attributes	
Max. contact rating	25 V / 2 A
Operation	Operated by direct or side-ward pressure
Response path	2 mm
Max. switching current	2 A
Length of connection slots	100 mm

Article / Feature	Order no.
Change-over contact; with connection lead, length 100 mm; 25V/2,0 A	1 0 4 0 0 - - - - - 0 0

Connecting cable



Connecting cable model 760
Connecting cable for model series 118® with clamp/
plug connection

Article / Feature	Order no.
For strikes; length 4,5 meters; 2 wires	7 6 0 - 1 4 - - - - - 0 0
For model series 118® with connection clampable/pluggable (AS and BS version); 1.5 m length	7 6 0 - 1 5 0 - - - - - 0 0
For model series 118® with connection clampable/pluggable (AS and BS version); 2.5 m length	7 6 0 - 2 5 0 - - - - - 0 0
For model series 118® with connection clampable/pluggable (AS and BS version); 4.5 m length	7 6 0 - 4 5 0 - - - - - 0 0

Pre-load electronic assembly



Pre-Load Electronic Assembly 760-12

Improves pre-load capability to at least 300N for DC operation. A short buzzing sound is audible in the electric strike for about 0.5 seconds. Continuous current-resistant, holding current is reduced. Compatible with standard effeff electric strikes.

Technical attributes	
Max. current consumption	500 mA
Length	34 mm
Width	23 mm
Height	16 mm
Connection terminal	2-pin

Article / Feature	Order no.
12 V DC / 24 V DC	7 6 0 - 1 2 - - - - - 0 0

Lead covers from effeff

All selection options at a glance

Width

effeff lead covers with one-sided and two-sided installation casing are 24 mm wide and therefore fit in almost all profiles:

- Simplified installation
- Less milling work

Flex cable

The flexible and spiral cable prevents cable breakage and achieves 1 million cycles in an internal test.

- No cable breakage

Mounting type

Depending on the requirements for the door or on the construction site, you can choose between surface or flush mounting:

- Surface mounting
- Flush mounting

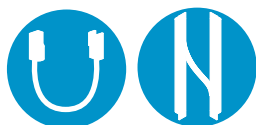

Installation casings

The lead covers are available without installation casing, with installation casing on one side or with casings on both sides.

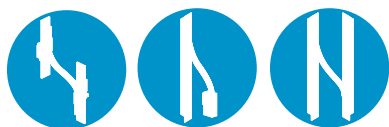

Number of poles

The more complex the technology on the door, the more poles are required to connect the electrical devices. Here, our lead covers convince with either 10 or 20 poles.

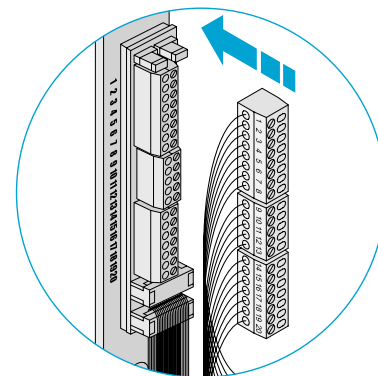

Terminal plug connection

The terminal plug connection enables:

- Separate production of door and frame
- Quick installation on the construction site
- Simple connection to the building installation
- Easy separation of service and maintenance work

Length

The choice of the length depends on how far the door needs to be opened. There are:

- Long version with max. rotation 200 mm
- Short version with max. rotation 100 mm

Mounting plates

- Mounting plate with radius
- Round end caps

For further information
can be found online at:
www.assaabloy.de/lead-cover



Lead covers

for open installation without installation casing



Lead cover for open installation

For direct power transmission from the door frame to the door leaf. Rust-resistant, flexible metal hose. Fixing caps for mounting on door frame and door leaf.

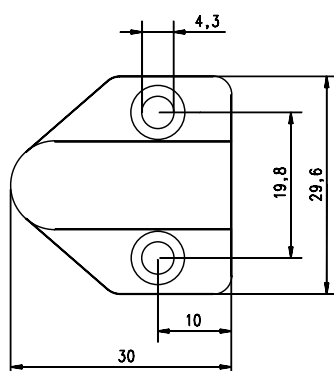

Article / Feature	Order no.
For open installation; nickel-coated brass; length 18 cm	1 0 3 1 8 - - - - - 0 0
For open installation; nickel-coated brass; length 30 cm	1 0 3 1 8 - 3 0 - - - - 0 0
For open mounting; nickel-plated brass; length 40 cm	1 0 3 1 8 - 4 0 - - - - 0 0
For open installation; nickel-coated brass; length 60 cm	1 0 3 1 8 - 6 0 - - - - 0 0
For open installation; nickel-coated brass; length 80 cm	1 0 3 1 8 - 8 0 - - - - 0 0
Nickel-coated brass; Length 10 m	1 0 3 1 8 - 1 - 1 0 - - - 0 0
Nickel-coated brass; Length 100 m	1 0 3 1 8 - 1 - 1 0 0 - - 0 0
For metal hose; nickel-plated brass; white	1 0 3 1 8 - 2 - - - - - 0 0
For flexible metal tube; nickel-coated brass	1 0 3 1 8 - 3 - - - - - 0 0
For open installation; white plastic-coated; Length 30 cm	1 0 3 1 8 W - - - - - 0 0
For open installation; white plastic-coated; Length 30 cm	1 0 3 1 8 W - 1 - 1 0 - - 0 0



Lead cover 10312-11

Lead cover for open installation or for concealed installation in door rebate with room dimension >16 mm.

Suitable for aluminium and synthetic profiles without installation casing.

Technical attributes	
Chamber dimension	> 16 mm
Material spiral hose	Stainless steel
Max. cable diameter	7 mm
Max. permissible horizontal rotation	100 mm
Length	288 mm
Width	16 mm
Depth	16 mm

Article / Feature	Order no.
Cable guide, concealed, short, without installation casing	1 0 3 1 2 - 1 1 - - - - 0 0



Lead cover 10312-21

Lead cover for open installation or for concealed installation in door rebate with room dimension >16 mm.

Suitable for aluminium and synthetic profiles without installation casing.

Technical attributes	
Chamber dimension	> 16 mm
Material spiral hose	Stainless steel
Max. cable diameter	7 mm
Max. permissible horizontal rotation	200 mm
Length	443 mm
Width	16 mm
Depth	16 mm

Article / Feature	Order no.
Cable guide, concealed, long, without installation casing	1 0 3 1 2 - 2 1 - - - - 0 0

Detailed dimensional drawings for the lead cover can be found online with us.

Lead covers for concealed installation



Concealed lead cover 10312-14

24 mm width installation casing
Lead cover for concealed installation
Suitable for feeding cables with installation housing on one side for wood, metal and synthetic profiles.
The 10313-24 accessory set with 2 curved end pieces lends itself as an accessory for the installation casing in wooden profiles.

Technical attributes	
Length	330 mm
Width	24 mm
Depth	17 mm
Version	Cable guide
Variant	Installation casing on one side
Material installation casing	Stainless steel
Material spiral hose	Stainless steel
Max. cable diameter	7 mm
Max. permissible horizontal rotation	100 mm

Article / Feature	Order no.
Cable guide, concealed, short, installation casing on one side	1 0 3 1 2 - 1 4 - - - - 0 0



Lead cover 10312-14-10

24 mm width installation casing
Lead cover for concealed installation
For feeding cable with installation casing on both sides.
Installation system for minimal chamber dimensions and unobstructed movement. This system is particularly suitable for door systems with reduced spacing for hinges and inside hinges.
The advantage of this installation type is being able to position the door nearly flush with the frame (<1 mm reveal when door is closed). Minimal gaps for door rotation, as with inside hinges, for instance, do not result in the door jamming.

Technical attributes	
Variant	Installation casing on both sides
Version	Cable guide
Material installation casing	Stainless steel
Material spiral hose	Stainless steel
Max. cable diameter	7 mm
Max. permissible horizontal rotation	100 mm
Length	330 mm
Width	24 mm
Depth	17 mm

Article / Feature	Order no.
Cable guide, concealed, short, installation casing on both sides	1 0 3 1 2 - 1 4 - 1 0 - - 0 0



Concealed cable Transition 10312-20

Lead cover for concealed installation
Suitable for feeding cables with installation housing on one side for wood, metal and synthetic profiles.
With mounting house for cable lock
The 10313-24 accessory set with 2 curved end pieces lends itself as an accessory for the switch box in wooden profiles

Technical attributes	
Version	Cable guide
Variant	Installation casing on one side
Material installation casing	Stainless steel
Material spiral hose	Stainless steel
Max. cable diameter	7 mm
Max. permissible horizontal rotation	200 mm
Length installation casing / cable housing	519 mm / 110 mm
Width installation casing / cable housing	24 mm / 16 mm
Depth installation casing / cable housing	17,5 mm / 32 mm

Article / Feature	Order no.
Cable guide, concealed, long, installation casing on one side	1 0 3 1 2 - 2 0 - - - - 0 0

Detailed dimensional drawings for the lead cover can be found online with us.

Lead covers for concealed installation



Concealed lead cover model 10312-20-20

Lead cover for concealed installation

For feeding cable with integrated cable tracking and installation casing on both sides. Installation system for minimal room dimensions and unobstructed movement. This system is particularly suitable for door systems with reduced spacing for hinges and inside hinges.

The advantage of this installation type is being able to position the door practically flush with the frame (<1mm reveal when door is closed). Minimal gaps for door rotation, as with inside hinges, for instance, do not result in the door jamming.

Technical attributes	
Version	Cable guide
Variant	Installation casing on both sides
Material installation casing	Stainless steel
Material spiral hose	Stainless steel
Max. cable diameter	7 mm
Max. permissible horizontal rotation	200 mm
Length installation casing / cable housing	519 mm / 110 mm
Width installation casing / cable housing	24 mm / 16 mm
Depth installation casing / cable housing	18 mm / 32 mm

Article / Feature	Order no.
Cable guide, concealed, long, installation casing on both sides	1 0 3 1 2 - 2 0 - 2 0 - - 0 0

Detailed dimensional drawings for the lead cover can be found online with us.

Lead covers

for concealed installation, terminal/plug-in 10-pin



10-pin plug-in lead cover 10314-20-20

Lead cover for concealed installation

With integrated break-proof flex cable, clamp-plug connection technology and installation housing on both sides.

Installation system for minimal room dimensions and unobstructed movement. This system is particularly suitable for door systems with reduced spacing for hinges and inside hinges.

The advantage of this installation type is being able to position the door nearly flush with the frame (<1 mm reveal when door is closed). Minimal gaps for door rotation, as with inside hinges, for instance, do not result in the door jamming.

Technical attributes	
Input operating voltage	24 V +20%
Contact resistance per signal	0.35 Ohm
Max. current consumption	1 A 100% ED, 4 A max. 1 sec. 10% ED
Variant	Installation casing on both sides
Version	Plug-in device
Material installation casing	Stainless steel
Material spiral hose	Stainless steel
Max. permissible horizontal rotation	200 mm
Length	519 mm
Width	24 mm
Depth	33 mm
Cycles at 180 turns	1000000
Signal transmission	10-pin

Article / Feature	Order no.
Terminal/plug-in 10-pin, concealed, long, installation casing on both sides	1 0 3 1 4 - 2 0 - 2 0 - - 0 0

Detailed dimensional drawings for the lead cover can be found online with us.

Lead covers

for concealed installation, terminal/plug-in 10-pin



Lead cover 10314-11

For direct power transmission from the door frame to the door leaf. Rust-resistant, flexible metal hose. Fixing caps for mounting on door frame and door leaf.

Technical attributes	
Input operating voltage	24 V +20%
Contact resistance per signal	0.21 Ohm
Max. current consumption	1 A 100% ED, 4 A max. 1 sec. 10% ED
Length mounting plate	200 mm
Area of application	Aluminium and plastic profiles
Version	Plug-in device
Variant	Without installation casing
Chamber dimension	> 16 mm
Material mounting plate / installation casing	Stainless steel
Material spiral hose	Stainless steel
Max. permissible horizontal rotation	100 mm
Width mounting plate	24 mm
Depth mounting plate	19 mm
Installation length	340 mm
Cycles at 180 turns	1000000
Signal transmission	10-pin

Article / Feature	Order no.
Terminal/plug-in 10-pin, concealed, short, without installation casing	1 0 3 1 4 - 1 1 - - - - 0 0



Lead cover 10314-21

For direct power transmission from the door frame to the door leaf. Rust-resistant, flexible metal hose. Fixing caps for mounting on door frame and door leaf.

Technical attributes	
Input operating voltage	24 V +20%
Contact resistance per signal	0.35 Ohm
Max. current consumption	1 A 100% ED, 4 A max. 1 sec. 10% ED
Length mounting plate	200 mm
Area of application	Aluminium and plastic profiles
Version	Plug-in device
Variant	Without installation casing
Chamber dimension	> 16 mm
Material mounting plate / installation casing	Stainless steel
Material spiral hose	Stainless steel
Max. permissible horizontal rotation	200 mm
Width mounting plate	24 mm
Depth mounting plate	19 mm
Installation length	490 mm
Cycles at 180 turns	1000000
Signal transmission	10-pin

Article / Feature	Order no.
Terminal/plug-in 10-pin, concealed, long, without installation casing	1 0 3 1 4 - 2 1 - - - - 0 0

Detailed dimensional drawings for the lead cover can be found online with us.

Lead covers

for concealed installation, terminal/plug-in 10-pin



Lead cover 10314-14

For direct power transmission from the door frame to the door leaf. Rust-resistant, flexible metal hose. Fixing caps for mounting on door frame and door leaf.

Technical attributes	
Input operating voltage	24 V +20%
Contact resistance per signal	0.21 Ohm
Max. current consumption	1 A 100% ED, 4 A max. 1 sec. 10% ED
Length installation casing / mounting plate	330 mm / 200 mm
Chamber dimension	> 16 mm
Installation length	340 mm
Version	Plug-in device
Variant	One-sided installation casing/ angular mounting plate
Material mounting plate / installation casing	Stainless steel
Material spiral hose	Stainless steel
Max. permissible horizontal rotation	100 mm
Width installation casing / mounting plate	24 mm / 24 mm
Depth installation casing / mounting plate	33 mm / 19 mm
Cycles at 180 turns	1.000 000
Signal transmission	10-pin

Article / Feature	Order no.
Terminal/plug-in 10-pin, concealed, short, installation casing on one side	1 0 3 1 4 - 1 4 - - - - 0 0



Lead cover 10314-20

Lead cover for concealed installation. With integrated flexible cable to prevent cable breakage. Clamp/plug connector technology, 10-pin. One-sided installation casing suitable for wood, metal and plastic profiles. The 10313-24 accessory set with 2 curved end pieces lends itself as an accessory for the installation casing in wooden profiles

Technical attributes	
Input operating voltage	24 V +20%
Contact resistance per signal	0.35 Ohm
Max. current consumption	1 A 100% ED, 4 A max. 1 sec. 10% ED
Cycles at 180 turns	1.000 000
Max. permissible horizontal rotation	200 mm
Version	Plug-in device
Variant	One-sided installation casing/ angular mounting plate
Material mounting plate / installation casing	Stainless steel
Material spiral hose	Stainless steel
Length installation casing / mounting plate	519 mm / 200 mm
Width installation casing / mounting plate	24 mm / 24 mm
Depth installation casing / mounting plate	33 mm / 19 mm
Signal transmission	10-pin

Article / Feature	Order no.
Terminal/plug-in 10-pin, concealed, long, installation casing on one side	1 0 3 1 4 - 2 0 - - - - 0 0

Detailed dimensional drawings for the lead cover can be found online with us.

Lead covers

for concealed installation, terminal/plug-in 10-pin



Lead cover 10314-14-10

24 mm width installation casing.

Lead cover for concealed installation.

With integrated break-proof flex cable, 10-pin clamp-plug connection technology and installation casing on both sides.

Installation system for minimal room dimensions and unobstructed movement. This system is particularly suitable for door systems with reduced spacing for hinges and inside hinges.

The advantage of this installation type is being able to position the door nearly flush with the frame (<1 mm reveal when door is closed). Minimal gaps for door rotation, as with inside hinges, for instance, do not result in the door jamming.

Technical attributes	
Input operating voltage	24 V +20%
Contact resistance per signal	0.21 Ohm
Max. current consumption	1 A 100% ED, 4 A max. 1 sec. 10% ED
Version	Plug-in device
Variant	Installation casing on both sides
Material installation casing	Stainless steel
Material spiral hose	Stainless steel
Max. permissible horizontal rotation	100 mm
Length	330 mm
Width	24 mm
Depth	33 mm
Cycles at 180 turns	1.000 000
Signal transmission	10-pin

Article / Feature	Order no.
Terminal/plug-in 10-pin, concealed, short, installation casing on both sides	1 0 3 1 4 - 1 4 - 1 0 - - 0 0



10-pin plug-in lead cover 10314-20-20

Lead cover for concealed installation.

With integrated break-proof flex cable, clamp-plug connection technology and installation housing on both sides.

Installation system for minimal room dimensions and unobstructed movement. This system is particularly suitable for door systems with reduced spacing for hinges and inside hinges.

The advantage of this installation type is being able to position the door nearly flush with the frame (<1 mm reveal when door is closed). Minimal gaps for door rotation, as with inside hinges, for instance, do not result in the door jamming.

Technical attributes	
Input operating voltage	24 V +20%
Contact resistance per signal	0.35 Ohm
Max. current consumption	1 A 100% ED, 4 A max. 1 sec. 10% ED
Variant	Installation casing on both sides
Version	Plug-in device
Material installation casing	Stainless steel
Material spiral hose	Stainless steel
Max. permissible horizontal rotation	200 mm
Length	519 mm
Width	24 mm
Depth	33 mm
Cycles at 180 turns	1.000 000
Signal transmission	10-pin

Article / Feature	Order no.
Terminal/plug-in 10-pin, concealed, long, installation casing on both sides	1 0 3 1 4 - 2 0 - 2 0 - - 0 0

Detailed dimensional drawings for the lead cover can be found online with us.

Lead covers

for concealed installation, terminal/plug-in 20-pin



Lead cover 10314-34

20-pin lead cover for power transmission between frame and leaf

Technical attributes	
Input operating voltage	24 V +20%
Max. current consumption jumper 1+2 connected	2 A 100% ED, 5 A max. 1 sec. 10% ED
Max. current consumption	1 A 100% ED, 4 A max. 1 sec. 10% ED
Contact resistance per signal	0.21 Ohm
Connecting cable	Plug-in device
Signal transmission	20-pin
Variant	One-sided installation casing/ angular mounting plate
Material mounting plate / installation casing	Stainless steel
Material spiral hose	Stainless steel
Max. permissible horizontal rotation	100 mm
Cycles at 180 turns	1.000 000
Length installation casing / mounting plate	330 mm / 200 mm
Width installation casing / mounting plate	24 mm / 24 mm
Depth installation casing / mounting plate	33 mm / 19 mm

Article / Feature	Order no.
Terminal/plug-in 20-pin, concealed, short, installation casing on one side	1 0 3 1 4 - 3 4 - - - - 0 0



Lead cover 10314-40

20-pin lead cover for power transmission between frame and leaf

Technical attributes	
Input operating voltage	24 V +20%
Max. current consumption jumper 1+2 connected	2 A 100% ED, 5 A max. 1 sec. 10% ED
Max. current consumption	1 A 100% ED, 4 A max. 1 sec. 10% ED
Contact resistance per signal	0.35 Ohm
Connecting cable	Plug-in device
Signal transmission	20-pin
Variant	One-sided installation casing/ angular mounting plate
Material mounting plate / installation casing	Stainless steel
Material spiral hose	Stainless steel
Max. permissible horizontal rotation	200 mm
Cycles at 180 turns	1.000 000
Length installation casing / mounting plate	519 mm / 200 mm
Width installation casing / mounting plate	24 mm / 24 mm
Depth installation casing / mounting plate	33 mm / 19 mm

Article / Feature	Order no.
Terminal/plug-in 20-pin, concealed, long, installation casing on one side	1 0 3 1 4 - 4 0 - - - - 0 0

Detailed dimensional drawings for the lead cover can be found online with us.

Lead covers

for concealed installation, terminal/plug-in 20-pin



Lead cover 10314R34

20-pin lead cover for power transmission between frame and leaf.

Technical attributes	
Input operating voltage	24 V +20%
Max. current consumption jumper 1+2 connected	2 A 100% ED, 5 A max. 1 sec. 10% ED
Max. current consumption	1 A 100% ED, 4 A max. 1 sec. 10% ED
Contact resistance per signal	0.21 Ohm
Connecting cable	Plug-in device
Signal transmission	20-pin
Variant	One-sided installation casing/ curved end mounting plate
Material mounting plate / installation casing	Stainless steel
Material spiral hose	Stainless steel
Max. permissible horizontal rotation	100 mm
Cycles at 180 turns	1.000 000
Length installation casing / mounting plate	330 mm / 228 mm
Width installation casing / mounting plate	24 mm / 24 mm
Depth installation casing / mounting plate	33 mm / 19 mm

Article / Feature	Order no.
Terminal/plug-in 20-pin, concealed, short, installation casing on one side with radius mounting plate	1 0 3 1 4 R 3 4 - - - - 0 0



Lead cover 10314R40

Lead cover for concealed installation.

With integrated flexible cable to prevent cable breakage. Clamp/plug connector technology, 20-pin.

With 2 jumpers to the bridge of PIN 1+2 as well as 3+4 for increase of power load.

One-sided installation casing and curved end mounting plate suitable for wooden profiles.

The 10313-24 accessory set with 2 curved end pieces lends itself as an accessory for the installation casing in wooden profiles

Technical attributes	
Input operating voltage	24 V +20%
Max. current consumption jumper 1+2 connected	2 A 100% ED, 5 A max. 1 sec. 10% ED
Contact resistance per signal	0.35 Ohm
Max. current consumption	1 A 100% ED, 4 A max. 1 sec. 10% ED
Connecting cable	Plug-in device
Variant	One-sided installation casing/ curved end mounting plate
Material mounting plate / installation casing	Stainless steel
Material spiral hose	Stainless steel
Max. permissible horizontal rotation	200 mm
Length installation casing / mounting plate	519 mm / 228 mm
Width installation casing / mounting plate	24 mm / 24 mm
Depth installation casing / mounting plate	33 mm / 19 mm
Cycles at 180 turns	1.000 000
Signal transmission	20-pin

Article / Feature	Order no.
Terminal/plug-in 20-pin, concealed, long, installation casing on one side with radius mounting plate	1 0 3 1 4 R 4 0 - - - - 0 0

Detailed dimensional drawings for the lead cover can be found online with us.

Lead covers

for concealed installation, terminal/plug-in 20-pin



Lead cover 10314-34-10

20-pin lead cover for power transmission between frame and leaf

Technical attributes	
Input operating voltage	24 V +20%
Max. current consumption jumper 1+2 connected	2 A 100% ED, 5 A max. 1 sec. 10% ED
Max. current consumption	1 A 100% ED, 4 A max. 1 sec. 10% ED
Contact resistance per signal	0.21 Ohm
Connecting cable	Plug-in device
Signal transmission	20-pin
Variant	Installation casing on both sides
Material installation casing	Stainless steel
Material spiral hose	Stainless steel
Max. permissible horizontal rotation	100 mm
Cycles at 180 turns	1.000 000
Length	330 mm
Width	24 mm
Depth	33 mm

Article / Feature	Order no.
Terminal/plug-in 20-pin, concealed, short, installation casing on both sides	1 0 3 1 4 - 3 4 - 1 0 - - 0 0



Lead cover 10314-40-20

20-pin lead cover for power transmission between frame and leaf

Technical attributes	
Input operating voltage	24 V +20%
Max. current consumption jumper 1+2 connected	2 A 100% ED, 5 A max. 1 sec. 10% ED
Max. current consumption	1 A 100% ED, 4 A max. 1 sec. 10% ED
Contact resistance per signal	0.35 Ohm
Connecting cable	Plug-in device
Signal transmission	20-pin
Variant	Installation casing on both sides
Material installation casing	Stainless steel
Material spiral hose	Stainless steel
Max. permissible horizontal rotation	200 mm
Cycles at 180 turns	1.000 000
Length	519 mm
Width	24 mm
Depth	33 mm

Article / Feature	Order no.
Terminal/plug-in 20-pin, concealed, long, installation casing on both sides	1 0 3 1 4 - 4 0 - 2 0 - - 0 0

Detailed dimensional drawings for the lead cover can be found online with us.

Lead covers

for concealed installation, terminal/plug-in 20-pin



Lead cover 10314-31

20-pin lead cover for power transmission between frame and leaf

Technical attributes	
Input operating voltage	24 V +20%
Max. current consumption jumper 1+2 connected	2 A 100% ED, 5 A max. 1 sec. 10% ED
Max. current consumption	1 A 100% ED, 4 A max. 1 sec. 10% ED
Contact resistance per signal	0.21 Ohm
Connecting cable	Plug-in device
Signal transmission	20-pin
Variant	Without installation casing
Chamber dimension	> 16 mm
Material mounting plate / installation casing	Stainless steel
Material spiral hose	Stainless steel
Max. permissible horizontal rotation	100 mm
Cycles at 180 turns	1.000 000
Length mounting plate	200 mm
Width mounting plate	24 mm
Depth mounting plate	19 mm
Installation length	340 mm

Article / Feature	Order no.
Terminal/plug-in 20-pin, concealed, short, without installation casing	1 0 3 1 4 - 3 1 - - - - 0 0



Lead cover 10314-41

20-pin lead cover for power transmission between frame and leaf

Technical attributes	
Input operating voltage	24 V +20%
Max. current consumption jumper 1+2 connected	2 A 100% ED, 5 A max. 1 sec. 10% ED
Max. current consumption	1 A 100% ED, 4 A max. 1 sec. 10% ED
Contact resistance per signal	0.35 Ohm
Connecting cable	Plug-in device
Signal transmission	20-pin
Variant	Without installation casing
Chamber dimension	> 16 mm
Material mounting plate / installation casing	Stainless steel
Material spiral hose	Stainless steel
Max. permissible horizontal rotation	200 mm
Cycles at 180 turns	1.000 000
Length mounting plate	200 mm
Width mounting plate	24 mm
Depth mounting plate	19 mm
Installation length	490 mm

Article / Feature	Order no.
Terminal/plug-in 20-pin, concealed, long, without installation casing	1 0 3 1 4 - 4 1 - - - - 0 0

Detailed dimensional drawings for the lead cover can be found online with us.

Lead covers with integrated IO-module



OneSystem IO module N5952

The OneSystem IO module is suitable for digital connection of OneSystem locks with Hi-O technology. The OneSystem IO module provides the connection to conventional devices, e.g. access control, on-site interlock controls or monitoring controls. To this end, it provides non-isolated inputs for external control and potential-free relay outputs for querying the function states of the locks for higher-level systems.

Three inputs for external release, external monitoring contact and external voltage-based release.

Two freely configurable outputs (can be assigned with the same function).

Technical attributes	
Input operating voltage	24V +20%
Max. current consumption	1 A 100% ED, 4 A max. 1 sec. 10% ED
Contact resistance per signal	0.21 Ohm
Signal transmission	5-pin
Length installation casing / mounting plate	330 mm / 180 mm; 519 mm / 250 mm
Width installation casing / mounting plate	24 mm/24 mm
Depth installation casing / mounting plate	17 mm, 3 mm
Material spiral hose	Stainless steel
Cycles at 180 turns	1.000 000

Article / Feature	Order no.
Lead cover concealed, one-sided installation casing, length 330mm, IO module on the mounting plate	N 5 9 5 2 0 0 1 4 0 0 0 S 0 0
Lead cover concealed, one-sided installation casing, length 330mm, IO module in the box	N 5 9 5 2 0 0 1 4 0 0 0 W 0 0
Lead cover concealed, one-sided installation casing, length 519mm, IO module on the mounting plate	N 5 9 5 2 0 0 2 0 0 0 0 S 0 0
Lead cover concealed, one-sided installation casing, length 519mm, IO module in the box	N 5 9 5 2 0 0 2 0 0 0 0 W 0 0

Detailed dimensional drawings for the lead cover can be found online with us.

Lead covers

Accessories



Mounting set model 10313

This saves time when installing the concealed lead covers (one-sided and on both sides) in wood structures. It consists of two radius end pieces and 5 stainless steel screws to fasten the installation housing and the plate on the opposite side. When using the 10313 installation set, only a cutout is required, with no finishing work. There is no longer the need to chisel out to fit the installation housing and the square fastening plate.

Technical attributes

Length	27,5 mm
Width	24 mm
Depth	18 mm

Article / Feature

Timber construction mounting set for lead covers with installation casing

Order no.

1 0 3 1 3 - 2 4 - - - - 0 0



Adapter plate set for wood structure Z09-ADL54

For the time-saving installation of the concealed lead cover series 10314... with rectangular screw-on plate (for variants with one-sided installation casing) in wood structures. When using the adapter plate set for wooden doors only a cutout is required with no finishing work. There is no longer the need to chisel out to fit the rectangular screw-on plate.

Technical attributes

Height	48 mm
Width	24 mm
Depth	6 mm

Article / Feature

Set for wooden doors

Order no.

Z 0 9 - A D L 5 4 - - - - 0 0

Order form

Please copy formular, complete and fax it back to ASSA ABLOY!

Customer-No.: _____

Address: _____
Company _____
Branch _____
Contact _____
Telephone _____
Fax _____
Email _____
Street / POB _____
Postal Code / Town _____

Order Date: _____

ASSA ABLOY
Sicherheitstechnik GmbH
Bildstockstrasse 20
72458 Albstadt
GERMANY
Tel. +49 7431 123-700
Fax +49 7431 123-258
export.effeff@assaabloy.com

Order Number	Pce.

Just fax to us on: **+49 7431 123-171** (Germany)
+49 7431 123-258 (worldwide)

Urgend orders can also be placed via email:

As an established partner for electric strike systems, ASSA ABLOY Sicherheitstechnik is known for its fast, reliable delivery of orders.
We offer two ordering options: You can fax the completed form to us or send us your requirements by email to **export.effeff@assaabloy.com**

Quotations and deliveries are made in accordance with our conditions of delivery and payment.

Goods return form

Please copy formular, complete and fax it
back to ASSA ABLOY!

ASSA ABLOY
Opening Solutions

Customer-Nr.:

Address:

Date:

ASSA ABLOY
Sicherheitstechnik GmbH
Bildstockstraße 20
72458 Albstadt
GERMANY
Tel. +49 7431 123-700
Fax +49 7431 123-258
export.effeff@assaabloy.com

We wish to make the
following return of goods:

Invoice No. / Date	Order No.	Quantity	Remarks

Please note:

Goods may only be returned if they are new, packed originally and without any marks of usage and installation.
They should be returned within 6 months of purchasing (date of dispatch).

Detailed statement: ☐ Yes

Reasons for return

To be filled in by the customer:

Reason for return

- ☐ Incorrect order
☐ Incorrect delivery
☐ Exchange
☐ Complaint
☐ Other

ASSA ABLOY offers the following options:

- ☐ Return with ____ % deduction
☐ Re-order free of charge
☐ Replacement delivery
☐ We regret these goods cannot be returned
☐ Other

Date Signature Customer / name

Date Signatur ASSA ABLOY

Simply fax to:

+49 7431 123-171 (Germany)
+49 7431 123-258 (worldwide)

Note:

Please ensure that this letter accompanies the returned goods.

The consignment will be returned carriage forward unless accompanied by a returns note with notice of prepayment. If you have any queries on matters in progress, please telephone +49 7431 123-700 or fax -258.

Our products – quality, know-how and innovation



Electric strikes

With electric strikes, you can unlock a door at the push of a button – without needing to go to the actual door yourself.

effeff electric strikes offer high standards of security and convenience and a suitable electric strike for every installation location. This we can guarantee worldwide as effeff takes into consideration both national and international rules and regulations.

effeff wins over with its certified and security electric strikes due to its sophisticated solutions for smoke protection doors, fire protection doors and doors along escape routes. Our wide range for high security areas

provides solutions for glass doors, sliding doors and clean room doors as well as for explosive areas or seal door systems.

- Standard electric strikes
- Smoke and fire protection electric strikes
- Escape door electric strikes
- Special electric strikes
- Accessories



MEDIATOR®

Entrance doors to apartment buildings – an issue which is always causing problems. Some people always lock the door, others never do.

With MEDIATOR, ASSA ABLOY Sicherheitstechnik now offers a simple, yet brilliant solution:

This innovative system ensures doors always lock automatically as soon as they close due to the self-locking escape door lock and an effeff linear electric strike.

The door can also be opened for visitors from inside apartments using the electric strike.

MEDIATOR can do much more than this, however.

It also ensures doors can be opened from the inside at any time using the door handle, even when doors are locked.

This means everyone can leave the building in the event of an emergency, whether they have a key or not. Apartment block entrance doors can be retrofitted with MEDIATOR quickly and easily at a very reasonable price.



Security locks

“Security lock” is the most accurate description of effeff locks. Security provides protection against intrusion, thus ensuring people and valuables are safe from harm. effeff lock products provide such comprehensive protection for you and your property. With their anti-panic function and self-locking systems, effeff’s security locks guarantee maximum mechanical security combined with maximum convenience for users.

- Mechanical security locks
- Microswitch security locks
- Motorized security locks
- Electric security locks
- Multipoint security locks
- Accessories



Access control

Whether the main or side entrance, strongroom, development department or laboratory, there are certain areas in buildings which need to be locked at all times.

Access control systems regulate access to protected areas, limiting entrance to authorised groups of people without needlessly disrupting their day-to-day business.

A straightforward solution for greater security, effeff access control systems protect and control buildings, individual rooms or other security-relevant areas.

We supply a comprehensive range of different technologies, devices and systems, which can be tailored to meet respective specific security needs.

effeff access control systems meet our clients’ individual requirements and are used in private and public buildings, the health sector, leisure facilities, industrial facilities and production plants.

- Access control door fittings
- Access control systems



Escape route technology

effeff's escape route systems fully comply with requirements for uncompromising personal safety and maximum protection for property.

You can depend on effeff's expertise and reliability in emergency situations. Our escape route systems guarantee safe operation of escape route doors, even though under normal circumstances doors may have integrated automatic locking systems or can only be opened by authorised users. Safer use of escape routes is assured at all times in the event of an emergency. effeff electric escape door control systems provide

protection and safety in places such as department stores, schools, kindergartens, office buildings, airports and exhibition halls.

We also supply ideal solutions for specific uses such as restricted areas in hospitals.

- Escape door locking systems
- Escape door monitoring



Electric bolt

effeff electric deadbolts are a reliable complement to locks and strikes used for specific requirements. They can be fitted to special doors such as swing doors or sliding doors, where they are often used as an additional locking device. Where doors are locked with an integrated monitoring contact, the locking status can be monitored, meaning, for instance, a system or machine can only start up if the door concerned is securely locked.

The bolt is suitable for a wide variety of uses, ranging from mere drawers through to doors in lifts and high security areas.

- Door dead bolts
- High security dead bolts
- Motorized dead bolts
- Cabinet locks



Electric holding magnets

A large selection of electric holding magnets is an important part of effeff's locking systems range. The effeff range includes authorised models for locking escape route doors as well as standard magnets. Thanks to low-noise operation and the benefits of retro-fitting, magnets are highly suitable as additional locking devices in doors.

- Electric magnets for inside and outside doors
- Electric magnets for escape door applications
- Electric magnets for holding doors open
- Accessories



Arrester systems

Whether the main or side entrance, strongroom, development department or laboratory, there are certain areas in buildings which need to be locked at all times. Access control systems regulate access to protected areas, limiting entrance to authorised groups of people without needlessly disrupting their day-to-day business. A straightforward solution for greater security, effeff access control systems protect and control buildings, individual rooms or other security-relevant areas. We supply a comprehensive range of different technologies, devices and systems, which can be tailored to meet respective specific security needs.

effeff access control systems meet our clients' individual requirements and are used in private and public buildings, the health sector, leisure facilities, industrial facilities and production plants.

- Access control door fittings
- Access control systems

In the future we'll also meet the demands for technical advances and innovations. We therefore reserve the right to make design modifications. Illustrations may thus also vary from the actual products.

Despite the greatest of care, printing errors or mistakes may be made. ASSA ABLOY accepts no responsibility in such cases and will not enter into any obligations of any kind.

No responsibility is taken for the correctness of any safety regulations reproduced.

Notes

[illegible]

The ASSA ABLOY Group is the global leader in access solutions. Every day we help people feel safe, secure and experience a more open world.

ASSA ABLOY
Opening Solutions

ASSA ABLOY
Sicherheitstechnik GmbH
Bildstockstrasse 20
72458 Albstadt
GERMANY
Tel. +49 7431 123-700
Fax +49 7431 123 258
albstadt@assaabloy.com
www.assaabloyopeningsolutions.de